

# JOINTS, FLANGES B.O.D.

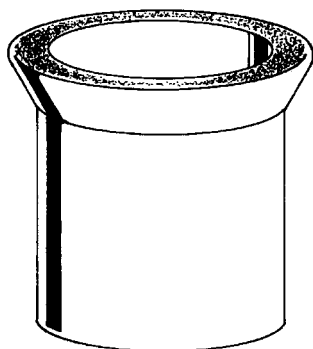

**CG-143**

## **CG-143 FLANGE, REACTION KETTLE, 102mm (4") ID**

Conical style flange has a 102mm (4") ID with a flat, ground surface used for construction of reaction kettles or flasks. Tooled on tubing having an ID of 105mm and an OD of 115mm. Supplied with approximately 7" of tubing below joint. Available tooled on longer lengths of tubing. Please contact us for details.

Part  
Number  
**CG-143-01**

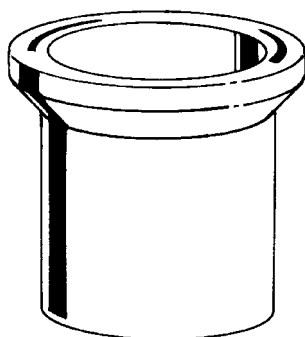

**CG-146**

## **CG-146 FLANGE, BUCHI®**

Replacement flange for use on Buchi® condensers and rotary evaporator flasks.

Part Number	Flange OD (mm)	Flange ID (mm)	Shank OD (mm)
CG-146-01	50	34	38.0
CG-146-03	90	67	76.2
CG-146-02	100	74	85.0
CG-146-04	110	85	95.3
CG-146-07	140	119	130.0
CG-146-10	145	119	130.0
CG-146-05	150	119	130.0
CG-146-06	209	176	190.0

## CG-147 REACTION KETTLE FLANGE, DURAN®, WITH O-RING GROOVE

Flange is formed with a groove in the flat portion of the mating surface to accept an o-ring. The flange also has a ground surface permitting assembly with either the CG-148 flat flange or CG-149 lid blank using grease. In the greased application, the o-ring groove prevents grease from entering the reaction kettle and causing possible contamination. Outer taper of flange is formed at a 45° angle to accept the CG-141 or CG-141-T clamp.

### FLANGE DIMENSIONS:

A Flange ID (mm)	B Flange OD (mm)	C Tubing OD (mm)	D Overall Height (mm)
60	100	70	50
100	138	110	60
120	158	130	60
150	184	155	75
200	242	215	75

Part Number	Flange ID (mm)
CG-147-01	60
CG-147-02	100
CG-147-03	120
CG-147-04	150
CG-147-05	200

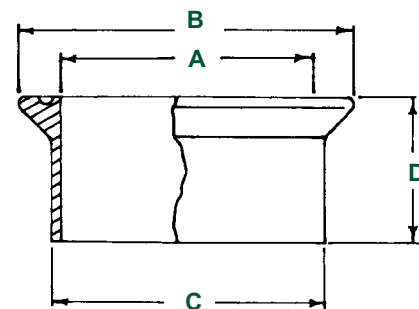

## CG-147 O-RING FOR REACTION VESSEL AND LID

O-ring for Chemglass reaction vessels and lids. Available in Viton, Silicone, Perfluoro, FEP encapsulated Silicone and FEP encapsulated stainless steel spring core. The stainless steel spring core maintains resilience even in long term exposure to cryogenic temperatures.

O-Ring Material	Temperature Range (°C)
Viton	-30 to 200
Silicone	-50 to 230
Perfluoro	-10 to 230
FEP-Silicone	-62 to 205
FEP-Stainless	-250 to 205

Part Number	O-Ring Material	Fits Flange ID (mm)
CG-147-20	Viton	60
CG-147-30	Silicone	60
CG-147-80	Perfluoro	60
CG-147-40	FEP-Silicone	60
CG-147-75	FEP-Stainless	60
CG-147-79	FEP-Stainless	80
CG-147-21	Viton	100
CG-147-31	Silicone	100
CG-147-82	Perfluoro	100
CG-147-41	FEP-Silicone	100
CG-147-76	FEP-Stainless	100
CG-147-22	Viton	120
CG-147-32	Silicone	120
CG-147-42	FEP-Silicone	120

LISTING CONTINUED ON NEXT PAGE...

CG-147



Perfluoro  
O-Rings Available

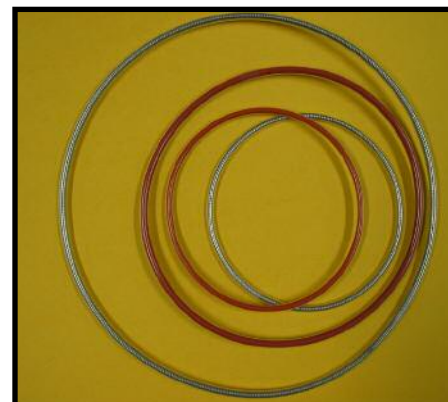

# JOINTS, FLANGES



Perfluoro  
O-Rings Available

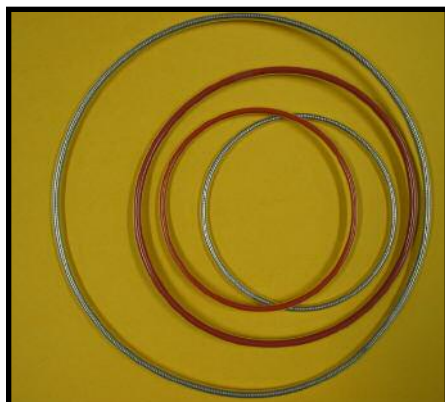

**CG-147**

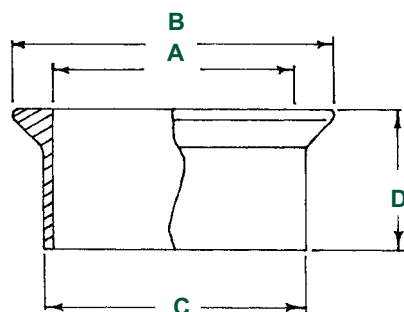

**CG-148**

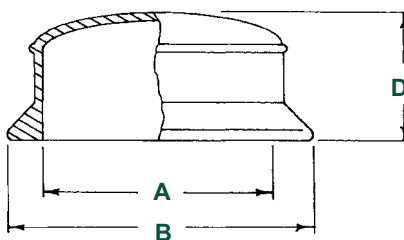

**CG-149**

LISTING CONTINUED FROM PREVIOUS PAGE...

## CG-147 O-RING FOR REACTION VESSEL AND LID

Part Number	O-Ring Material	Fits Flange ID (mm)
CG-147-23	Viton	150
CG-147-33	Silicone	150
CG-147-83	Perfluoro	150
CG-147-43	FEP-Silicone	150
CG-147-77	FEP-Stainless	150
CG-147-24	Viton	200
CG-147-34	Silicone	200
CG-147-84	Perfluoro	200
CG-147-44	FEP-Silicone	200
CG-147-78	FEP-Stainless	200

## CG-148 REACTION KETTLE FLANGE, DURAN®, FLAT GROUND

Similar to CG-147, but formed without the o-ring groove. Dimensions are the same as CG-147.

Part Number	Flange ID (mm)
CG-148-01	60
CG-148-02	100
CG-148-03	120
CG-148-04	150
CG-148-05	200

## CG-149 REACTION KETTLE LID, DURAN, FLAT GROUND

Dome style lid for construction of single or multiple neck reaction kettle heads. Mating surface is ground. Outer taper of flange is formed at a 45° angle to accept the CG-141 or CG-141-T clamps.

### LID DIMENSIONS:

A Flange ID (mm)	B Flange OD (mm)	D Overall Height (mm)
60	100	42
100	138	65
120	158	70
150	184	70
200	242	95

Part Number	Lid ID (mm)
CG-149-01	60
CG-149-02	100
CG-149-03	120
CG-149-04	150
CG-149-05	200

# JOINTS, FLANGES

## CG-141 CLAMP FOR DURAN® REACTION FLANGES AND LIDS

Made entirely from stainless steel, these clamps have three sections that firmly hold flanges and lids together. Quick release mechanism has a screw adjustment for tension applied to the flange.

Part Number	For Flange Size
CG-141-01	60
CG-141-02	100
CG-141-03	120
CG-141-04	150
CG-141-05	200



CG-141

## CG-141-T CLAMP FOR REACTION FLANGES AND LIDS, TEFLON COATED

Similar to CG-141 but with the entire clamp Teflon coated for chemical durability.

Part Number	For Flange Size
CG-141-T-11	60
CG-141-T-10	80
CG-141-T-12	100
CG-141-T-14	150
CG-141-T-15	200

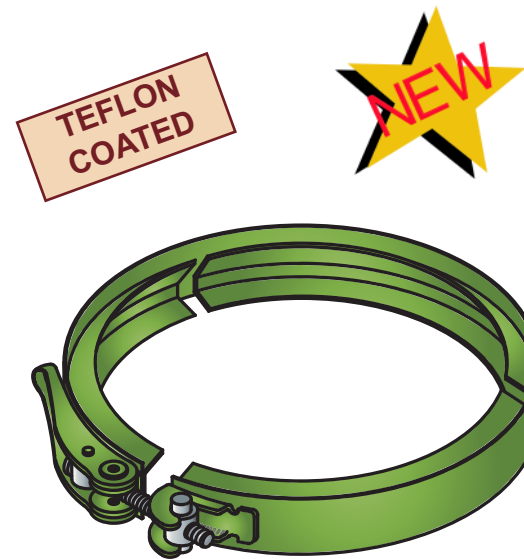

CG-141-T

# JOINTS, RODAVISS®

## RODAVISS® JOINTS

Unique design of the Rodaviss® joint provides for a greaseless high vacuum seal while firmly holding glassware together without a clamp. Outer member is externally threaded to accept a CG-182 cap, and when used with the corresponding CG-305 o-ring forms the grease-free seal. The inner member has a ring formed on the shank which permits the inner and outer to be separated using the CG-184 loosening ring. Outer joint can be used with a standard CG-100 inner joint of the same size, but without the option to pull joints apart in the event of freezing.



CG-170

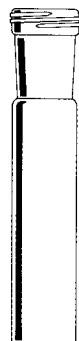

CG-172



CG-174

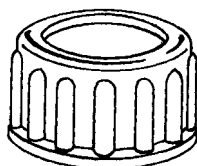

CG-182



CG-184

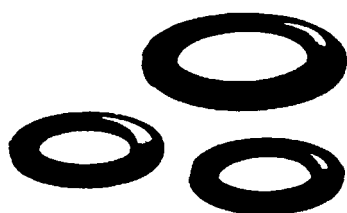

### CG-170 GROUND JOINT, RODAVISS®, INNER

With tooled ring on shank for use with CG-184 loosening ring.

Part Number	Joint Size
CG-170-01	14/20
CG-170-05	24/40
CG-170-08	45/50

### CG-172 GROUND JOINT, RODAVISS®, OUTER

Threaded outer to accept CG-182 or CG-186 caps.

Part Number	Joint Size
CG-172-01	14/20
CG-172-05	24/40
CG-172-08	45/50

### CG-174 GROUND JOINT, RODAVISS®, INNER WITH DRIP

Similar to CG-170, but with a drip tip cut at a 45° angle.

Part Number	Joint Size
CG-174-01	14/20
CG-174-05	24/40
CG-174-08	45/50

### CG-182 JOINT CAP, WITH HOLE, RODAVISS®

Threaded cap fits CG-172 outer joint. When used with CG-305 Viton o-rings, provides for greaseless high vacuum seal.

Part Number	Size
CG-182-01	14
CG-182-03	24
CG-182-06	45

### CG-184 LOOSENING RING, POLYAMIDE, RODAVISS®

Split polyamide ring to enable inner and outer Rodaviss® members to be pulled apart in the event of freezing.

Part Number	Size
CG-184-01	14
CG-184-03	24
CG-184-06	45

### CG-305 O-RING, VITON, RODAVISS® JOINT

Viton o-ring for use with a CG-182 cap on Rodaviss® outer joint.

Part Number	Size	O-ring Size	Pkg Qty
CG-305-112	14	112	12
CG-305-212	24	212	6
CG-305-223	45	223	3

# JOINTS, SVL® THREAD

## CG-187 SCREW THREAD TUBE, SVL®

Screw thread tube for replacement of apparatus using the SVL® series of glass threads. For use with a CG-188 solid cap with PTFE liner or a CG-189 open top cap and sealing ring for use as a tubing connector. Threads are tooled on one end of a 6" length of tubing.

### SVL® THREAD DIMENSIONS (mm):

Thread Size	A OD	B Height	C ID	D Tubing OD
15	16.2	11.0	10.8	16.0
22	23.0	12.5	17.5	22.0
30	31.4	17.5	24.5	32.0

Part Number	Thread Size	Tubing OD x Wall (mm)	Overall Length (mm)
CG-187-01	15	15 x 1.8	165
CG-187-02	22	22 x 1.8	165
CG-187-03	30	32 x 2.0	165

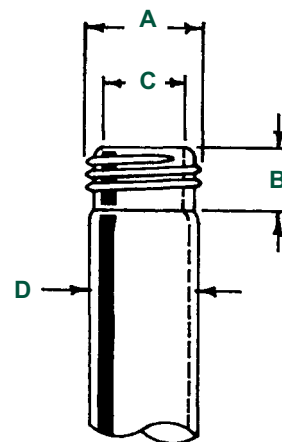

CG-187

## CG-188 SOLID CAP. PTFE PROTECTED SEAL, SVL®

Solid cap for use with CG-187 screw threads. Caps come complete with PTFE faced liner. Cap and liner are autoclavable to 121°C.

Part Number	Thread Size
CG-188-01	15
CG-188-02	22
CG-188-03	30

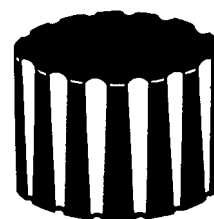

CG-188

## CG-189 CAP WITH APERTURE, SEALING RING, SVL®

Open top screw cap supplied complete with PTFE sealing ring to accept the tubing size as listed.

Part Number	Thread Size	Fits Tubing OD (mm)
CG-189-01	15	5.60 to 6.40
CG-189-02	22	13.6 to 14.4
CG-189-03	22	15.6 to 16.4
CG-189-04	30	17.6 to 18.4

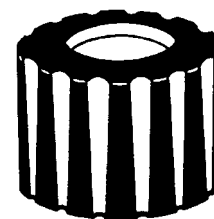

CG-189

# JOINTS, G.P.I. THREADS

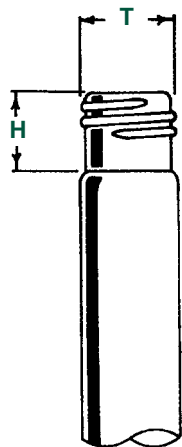

**CG-190**

## CG-190 REPLACEMENT THREAD, G.P.I.

Thread for replacement on apparatus using G.P.I. (Glass Packaging Institute) thread. These threads are used primarily on products manufactured in the United States. When a thread is designated as 20-400 it means that the diameter across the top of the threaded area is ~20mm. The numerical 400 designates a specific style of the finish. The following chart shows both the "T" and "H" dimension for use in identifying the thread. If the chart does not contain a dimension for style or size thread, this thread is not available. **NOTE: G.P.I. THREADS ARE SOLD IN PACKAGES ONLY.**

"T" (mm)	"H" (mm)					
	400	410	415	425	430	440
8	---	---	---	6.52	---	---
13	---	---	11.22	7.50	---	---
15	---	---	13.90	7.50	---	---
18	9.05	13.03	15.42	---	15.34	---
22	9.50	14.60	21.01	---	---	---
24	10.25	16.15	24.05	---	16.43	---
28	10.25	17.73	27.23	---	18.39	---
38	9.85	---	---	---	24.03	---
51	9.98	---	---	---	---	---
100	14.28	---	---	---	---	21.20

Part Number	Thread Size	Tubing OD (mm)	Approx Overall Length (mm)	Threads Per Pkg
CG-190-02	13-425	12	100	12
CG-190-03	15-425	16	100	12
CG-190-05	18-415	19	125	12
CG-190-06	20-400	19	135	12
CG-190-08	24-410	22	150	12
CG-190-10	28-400	25	125	8
CG-190-14	38-430	35	150	8
CG-190-15	51-400	46	125	4
CG-190-16	100-440	110	175	1

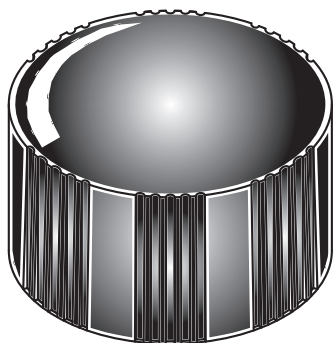

**CG-191**

## CG-191 SOLID CAP, G.P.I. SCREW THREAD

Cap for use with CG-190 G.P.I. screw threads. Part numbers CG-191-01 through CG-191-12 are made of black plastic with a choice of white rubber or Teflon liner. Part number CG-191-14 is made of blue polypropylene with a detachable Teflon liner. **NOTE: CAPS SOLD IN PACKAGES ONLY.**

Part Number	Thread Size	Liner Type	Pkg Qty
CG-191-01	13-425	Rubber	100
CG-191-02	13-425	Teflon	25
CG-191-03	15-425	Rubber	100
CG-191-04	15-425	Teflon	25
CG-191-05	18-415	Teflon	25
CG-191-06	20-400	Rubber	100
CG-191-07	20-400	Teflon	25
CG-191-08	24-400	Rubber	100
CG-191-09	24-400	Teflon	25
CG-191-10	28-400	Teflon	25
CG-191-11	38-430	Rubber	25
CG-191-12	38-430	Teflon	10
CG-191-13	51-400	Rubber	25
CG-191-14	100-440	Teflon	1

# JOINTS, GL THREADS

## CG-194 SCREW THREAD TUBE, GL

Screw thread tube for replacement on apparatus using the GL thread which is manufactured to I.S.O. specifications (GL is the I.S.O. designation for GLASS). To be used with a CG-196 solid cap with liner or a CG-195 cap with aperture and CG-197 silicone sealing ring.

### GL THREAD DIMENSIONS (mm):

GL Size	A OD	B Height	C ID	D Tubing OD
14	13.75	12.0	8.45	12.0
18	17.50	15.5	11.0	16.0
25	24.50	18.5	18.0	22.0
32	31.50	16.0	23.0	28.0
45	44.50	26.0	34.5	40.0

Part Number	GL Size	Tubing Dimensions OD x Wall (mm)	Overall Length (mm)
CG-194-01	14	12 x 1.5	100
CG-194-02	18	16 x 1.8	100
CG-194-03	25	22 x 1.8	100
CG-194-04	32	28 x 2.0	100
CG-194-05	45	40 x 2.3	100

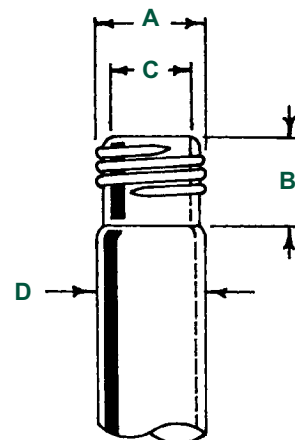

CG-194

## CG-195 CAP WITH APERTURE, GL THREAD

Open top cap for use with GL screw threads. The cap combined with the CG-197 sealing ring will accommodate tubing of the listed diameter. Cap is made from PBTE (thermoplastic polyester) and will withstand temperatures from -45 to 200° C.

Part Number	Thread Size	Aperture Size (mm)
CG-195-01	14	9.5
CG-195-02	18	11.0
CG-195-03	25	15.0
CG-195-04	32	20.0
CG-195-05	45	34.0

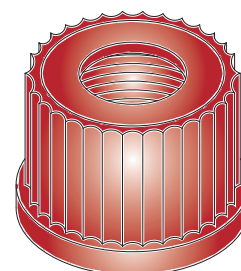

CG-195

## CG-195-H CAP WITH APERTURE, GL THREAD, HIGH TEMPERATURE

Open top cap for use with GL screw threads. The cap combined with the CG-197 sealing ring will accommodate tubing of the listed diameter. Cap is made from PPS (polyphenylsiloxan) and will withstand temperatures up to 250° C.

Part Number	Thread Size	Aperture Size (mm)
CG-195-H-01	GL-14	9.5
CG-195-H-02	GL-18	11.0



CG-195-H

SEE PAGE 287 FOR HIGH TEMPERATURE HOSE CONNECTIONS.

# JOINTS, GL THREADS

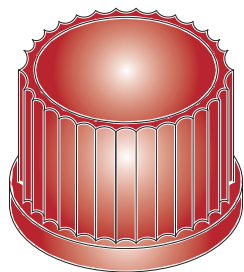

**CG-196**

## CG-196 SOLID CAP, PTFE SEAL, GL THREAD

Cap is made from PBTE (thermoplastic polyester) and will withstand temperatures from -45 to 200°C. PTFE seal is available separately.

### Caps Complete with PTFE Seal:

Part Number	GL Size
CG-196-01	14
CG-196-02	18
CG-196-03	25
CG-196-04	32
CG-196-05	45

### PTFE Seal Only:

Part Number	GL Size
CG-196-10	14
CG-196-11	18
CG-196-12	25
CG-196-13	32
CG-196-14	45

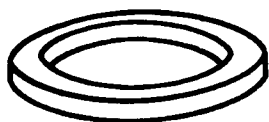

**CG-197**

## CG-197 SILICONE SEALING RING, GL THREAD

Seal is made from silicone with a vulcanized PTFE washer having an aperture to fit the listed tubing size. For use with CG-195 or CG-195-H cap. Other sizes are available. Please call for pricing.

Part Number	GL Size	Fits Tubing OD (mm)
CG-197-01	14	5.5 to 6.5
CG-197-02	18	5.5 to 6.5
CG-197-06	18	9.0 to 11.0
CG-197-03	25	11.0 to 13.0
CG-197-07	25	7.5 to 9.0
CG-197-04	32	11.0 to 13.0
CG-197-05	45	25.0 to 27.0

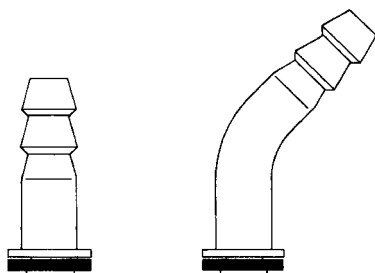

**CG-198**

## CG-198 REMOVABLE HOSE CONNECTION, GL THREAD

Polypropylene hose connections with a silicone rubber seal for use with GL-14 or GL-18 glass screw threads. Enables the connection of cooling or vacuum hose by simply screwing either style (straight or bent) onto the glass thread instead of forcing Tygon tubing over a serrated glass connector. Both styles have an OD of 8mm and an ID of 4mm. The bent style hose connection is bent at a 45° angle with an overall length of 40mm. The straight style has an overall length of 25mm.

Part Number	Thread Size	Style
CG-198-01	GL-14	Bent
CG-198-02	GL-14	Straight
CG-198-04	GL-18	Bent
CG-198-05	GL-18	Straight

# JOINTS, GL/CHEM THREADS

## CG-198-H REMOVABLE HOSE CONNECTION, GL THREAD, HIGH TEMPERATURE

PFA hose connections with a Viton rubber seal for use with GL-14 or GL-18 glass screw threads. Enables the connection of cooling or vacuum hose by simply screwing either style (straight or bent) onto the glass thread instead of forcing tubing over a serrated glass connector. Connection will withstand temperatures up to 250° C.

Part Number	Thread Size	Style	Hose OD (mm)	Hose ID (mm)	Length (mm)
CG-198-H-10	GL-14	Straight	8.7	6	45
CG-198-H-12	GL-18	Straight	10.5	7	51
CG-198-H-14	GL-14	Bent	8.7	6	49
CG-198-H-16	GL-18	Bent	10.5	7	65



CG-198-H

## CHEM-THREAD THREADED GLASS CONNECTOR

Chemglass threaded connector is a grease-free method of connection which is an efficient and convenient substitute for a standard ground glass joint. The Chem-Thread offers a quick, vacuum tight (10-5 Torr) and adjustable connection. Metal, plastic or glass tubing can be connected to your apparatus via a Chem-Thread thereby eliminating costly graded seals and special fittings.

When purchased complete, a Chem-Thread consists of three components: an externally threaded glass tube, a Celcon® polymer compression cap and a Viton o-ring. When the cap is tightened onto the glass tube, the o-ring is compressed downward and inward onto the connecting tube by means of the internal taper of the Celcon® cap.

## CG-350 CHEM-THREAD, COMPLETE

Consists of an externally threaded glass tube, Viton o-ring and Celcon® compression cap. Tube OD listed is the shank OD of the connector.

Part Number	Thread Size	Tube OD (mm)	Accepts Tubing OD (mm)	O-Ring Size
CG-350-10	4	9	2 to 4	201
CG-350-01	7	11	4 to 7	107
CG-350-02	9	13	7 to 9	110
CG-350-06	12	17	9 to 12	205
CG-350-03	15	19	12 to 15	206
CG-350-04	18	22	14 to 18	208
CG-350-05	25	32	22 to 25	317



CG-350

## CG-351 CHEM-THREAD, GLASS PORTION ONLY

Threaded glass portion only of Chem-Thread.

Part Number	Thread Size	Tube OD (mm)
CG-351-10	4	9
CG-351-01	7	11
CG-351-02	9	13
CG-351-06	12	17
CG-351-03	15	19
CG-351-04	18	22
CG-351-05	25	32

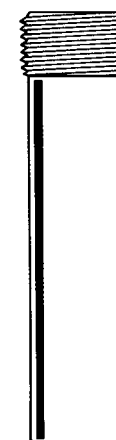

CG-351

# JOINTS, CHEM-THREADS

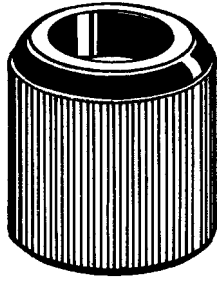

**CG-352**

## CG-352 CHEM-THREAD, CELCON COMPRESSION CAP WITH APERTURE

Celcon® compression cap with listed hole size for Chem-Threads. Will accept tubing sizes listed under CG-350.

Part Number	Thread Size
CG-352-10	4
CG-352-01	7
CG-352-02	9
CG-352-06	12
CG-352-03	15
CG-352-04	18
CG-352-05	25

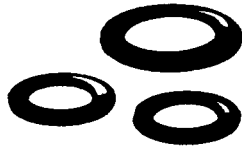

**CG-305**

## CG-305 O-RING, VITON, FOR USE WITH CHEM-THREAD

Viton o-ring for use with the Chem-Thread of listed size. Other o-rings are available. See CG-303 for Ethylene Propylene (E.P.), CG-308 for Kalrez®, and CG-309 for Perfluoro o-rings.

Part Number	O-Ring Size	For Use With Chem-Thread Size	Pkg Qty
CG-305-201	201	4	12
CG-305-107	107	7	12
CG-305-110	110	9	12
CG-305-205	205	12	6
CG-305-206	206	15	6
CG-305-208	208	18	6
CG-305-317	317	25	1



**CG-354**

## CG-354 THERMOCOUPLE CONNECTION, STAINLESS STEEL

Connector allows for easy connection of a thermocouple gauge tube to glass vacuum system without the use of a glass to metal graded seal or Cajon® fitting. Gauge connection consists of a GL-25 thread, a stainless steel bushing, and an open top GL-25 screw cap. The thermocouple gauge tube is threaded into the #303 stainless steel bushing and inserted into the glass GL-25 thread.\*

Part Number	Description
CG-354-10	Connection, Complete, GL-25

### Replacement Components:

Part Number	Description
AF-0306-10	Stainless Steel Bushing, 1/8" Female NPT, GL-25
CG-354-11	GL-25 Screw Thread for Thermocouple Bushing
CG-305-112	#112 Viton O-Ring, 12/pkg
CG-305-114	#114 Viton O-Ring, 12/pkg
CG-195-03	GL-25 Open Top Screw Cap

\*Not supplied with thermocouple gauge tube

# JOINTS, INTERNAL THREADS

## CG-360 INTERNAL THREAD, GLASS PORTION ONLY

Internal glass thread for use with CG-362 thru CG-366 bushings. Tubing OD listed is the shank OD of the thread.

Part Number	Thread Size	OD (mm)	Accepts Tubing ID (mm)
CG-360-01	7	12.7	6-7
CG-360-02	11	16	9-10.5
CG-360-03	15	22	12.5-14
CG-360-05	25	32	24.25
CG-360-06	50	57	47-48



CG-360

## CG-362 BUSHING, INTERNAL, FRONT SEAL, OPEN TOP

Front seal open top bushing for use with CG-360 internal threads. Supplied complete with Viton o-ring of the listed size.

Part Number	Thread Size	Opening (mm)	Material	O-Ring Size
CG-362-01	7	7.5	Nylon	008
CG-362-02	11	10	Teflon	012
CG-362-03	15	14	Teflon	110
CG-362-05	25	26	Teflon	212
CG-362-06	50	49	Teflon	225

### Replacement Components:

Part Number	Description	Pkg Qty
CG-305-008	#008 Viton O-Ring	12
CG-305-012	#012 Viton O-Ring	12
CG-305-110	#110 Viton O-Ring	12
CG-305-212	#212 Viton O-Ring	6
CG-305-225	#225 Viton O-Ring	3
CG-309-008	#008 Perfluoro O-Ring	1
CG-309-012	#012 Perfluoro O-Ring	1
CG-309-110	#110 Perfluoro O-Ring	1
CG-309-212	#212 Perfluoro O-Ring	1
CG-309-225	#225 Perfluoro O-Ring	1

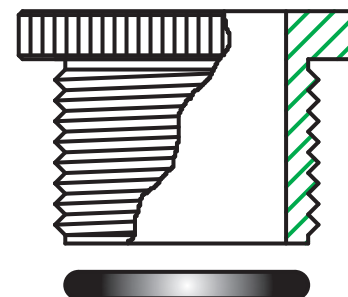

CG-362

# JOINTS, INTERNAL THREADS

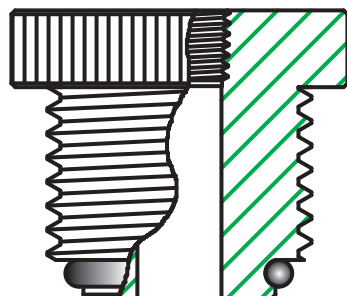

**CG-364**

## CG-364 BUSHING, INTERNAL, FRONT SEAL, FEMALE NPT

New front seal Teflon bushing with female NPT for use with CG-360 internal threads. Supplied complete with Viton o-ring of the listed size. See CG-305 for Viton and CG-309 for Perfluoro replacement o-rings. Other NPT sizes are available. Please call for pricing.

### 1/8" FEMALE NPT:

Part Number	Thread Size	NPT Thread Size (in)	O-Ring Size
CG-364-20	7	1/8	008
CG-364-30	11	1/8	012
CG-364-40	15	1/8	110
CG-364-60	25	1/8	212
CG-364-50	50	1/8	225

### 1/4" FEMALE NPT:

Part Number	Thread Size	NPT Thread Size (in)	O-Ring Size
CG-364-22	7	1/4	008
CG-364-32	11	1/4	012
CG-364-42	15	1/4	110
CG-364-62	25	1/4	212
CG-364-52	50	1/4	225

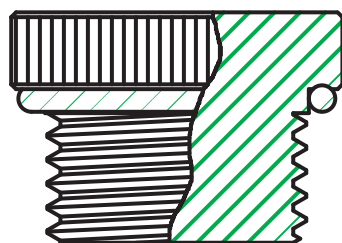

**CG-363**

## CG-363 BUSHING, INTERNAL, BACK SEAL, SOLID

Back seal solid bushing for use with CG-360 internal threads. Supplied complete with Viton o-ring of the listed size.

Part Number	Thread Size	Material	O-Ring Size
CG-363-02	11	Teflon	114
CG-363-03	15	Teflon	210
CG-363-05	25	Teflon	220
CG-363-06	50	Teflon	229

### Replacement Components:

Part Number	Description	Pkg Qty
CG-305-114	#114 Viton O-Ring	12
CG-305-210	#210 Viton O-Ring	6
CG-305-220	#220 Viton O-Ring	6
CG-305-229	#229 Viton O-Ring	3
CG-309-114	#114 Perfluoro O-Ring	1
CG-309-210	#210 Perfluoro O-Ring	1
CG-309-220	#220 Perfluoro O-Ring	1
CG-309-229	#229 Perfluoro O-Ring	1

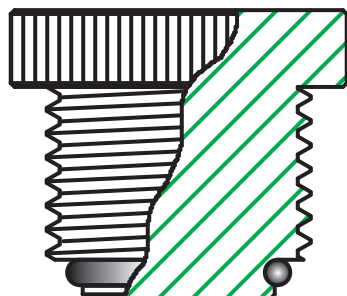

**CG-366**

## CG-366 BUSHING, INTERNAL, FRONT SEAL, SOLID

New front seal solid Teflon bushing for use with CG-360 internal threads. Supplied complete with Viton o-ring of the listed size. See CG-305 for Viton and CG-309 for Perfluoro replacement o-rings listed under CG-362.

Part Number	Thread Size	O-Ring Size
CG-366-11	11	012
CG-366-12	15	110
CG-366-13	25	212
CG-366-14	50	225